

MR Sightseeing Elevator

Hoistway Structure

Concrete Brick & Concrete Other

Unstandard Standard

NOTE

Technical Requirement:

HW	HOISTWAY WIDTH	CW	CAR INSIDE WIDTH	Type	TGJ630 / 1.0 -VF		
HD	HOISTWAY DEPTH <td>CD</td> <td>CAR INSIDE DEPTH <td>F/P/D</td> <td>/</td> <td>/</td> <td>Door type Center open</td> </td>	CD	CAR INSIDE DEPTH <td>F/P/D</td> <td>/</td> <td>/</td> <td>Door type Center open</td>	F/P/D	/	/	Door type Center open
OP	DOOR OPENING WIDTH <td>CH</td> <td>CAR HEIGHT <td>load</td> <td>630</td> <td>kg</td> <td>speed 1.0 m/s</td> </td>	CH	CAR HEIGHT <td>load</td> <td>630</td> <td>kg</td> <td>speed 1.0 m/s</td>	load	630	kg	speed 1.0 m/s
ROP	WALL OPENING WIDTH <td>MRW</td> <td>MACHINE ROOM WIDTH <td>Machine</td> <td>MCK200</td> <td>Roping</td> <td>2:1</td> </td>	MRW	MACHINE ROOM WIDTH <td>Machine</td> <td>MCK200</td> <td>Roping</td> <td>2:1</td>	Machine	MCK200	Roping	2:1
OPH	DOOR OPENING HEIGHT <td>MRD</td> <td>MACHINE ROOM DEPTH <td>T/sheave</td> <td>φ 4.00</td> <td>D/sheave</td> <td>φ 4.00</td> </td>	MRD	MACHINE ROOM DEPTH <td>T/sheave</td> <td>φ 4.00</td> <td>D/sheave</td> <td>φ 4.00</td>	T/sheave	φ 4.00	D/sheave	φ 4.00
OH	OVERHEAD HEIGHT <td>MRH</td> <td>MACHINE ROOM HEIGHT <td>car sheave</td> <td>φ 4.00</td> <td>CW sheave</td> <td>φ 4.00</td> </td>	MRH	MACHINE ROOM HEIGHT <td>car sheave</td> <td>φ 4.00</td> <td>CW sheave</td> <td>φ 4.00</td>	car sheave	φ 4.00	CW sheave	φ 4.00
CAR DBG	DISTANCE BETWEEN CAR GUIDE RAILS			Shaft	HW 2200 mm x HD 1650 mm		
CWT DBG	DISTANCE BETWEEN COUNTERWEIGHT GUIDE RAILS			Cabin	CW 1400 mm x CD 1100 mm		
				Door	OP 800 mm x OPH 2100 mm		

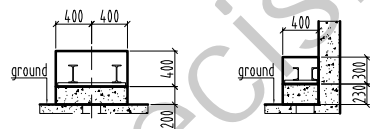

A, reserved hole/1:60 C, reserved hole/1:60

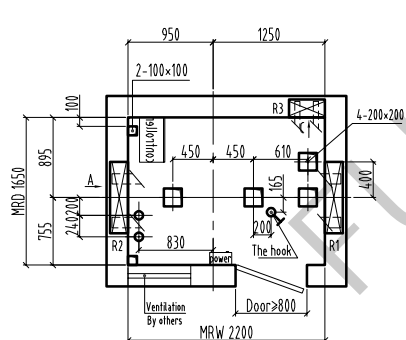

Machine room plan/1:60

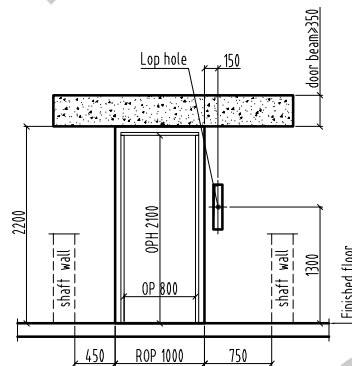

E/reserved hole/1: 60

Bottom box Lop: 100x500 (base station) 100x400 (remaining stations)
No bottom box Lop hole: φ50 hole

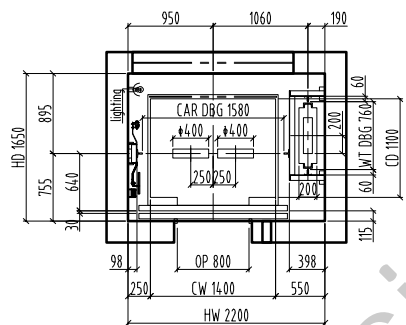

Hoistway plan/1:60

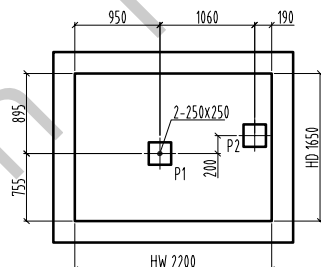

Pit plan/1: 60

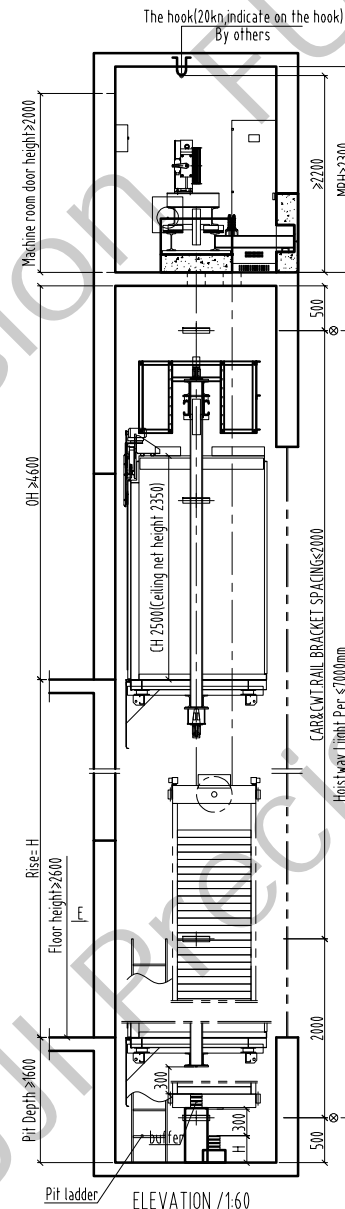

ELEVATION /1:60

OH	>=4600
Rise	H
26 F	
25 F	
24 F	
23 F	
22 F	
21 F	
20 F	
19 F	
18 F	
17 F	
16 F	
15 F	
14 F	
13 F	
12 F	
11 F	
10 F	
9 F	
8 F	
7 F	
6 F	
5 F	
4 F	
3 F	
2 F	
1 F	
G F	
B F	
Pit	>=1600
Floor	Height

Drawing	FTG 630 - 03-	approver	
Drawing No.	FTG 630 - 03-		
manufacturing no.			
Project name			

FUJI PRECISION

When v<1.0m/s, H=300; when 1.0m/s<v<1.75m/s, H=800.